

CERTIFIED RECORD OF LAND CORNER MONUMENTATION

History of original corner establishment:

The original corner was set in 1881 by Robb and Gradon under Contract No. 383, dated March 26, 1881.

The original notes state:

North between Secs 7 & 8

80.00 Set stone 16x12x8 for cor to secs 5,6,7&8 from which

A pine 24 in dia bears N 53° W, 50 lks dist

A pine 10 in dia bears N 54° E, 30 lks dist

A pine 14 in dia bears S 60° E, 41 lks dist

A Fir 7 in dia bears S 45° W, 65 lks dist

DIAGRAM

T10S T32E

S61S5

----+----

S71S8

Description of corner evidence found:

In the vicinity of the corner, I found a 17x14x7" (16x13x7") stone partially buried but not firmly set, 5 grooves on the down side, lying on its side N 70° W, 5.5 ft from the position established by the two remaining standing BTs. The corner position falls in a skid trail and I believe that the monument has been moved from the original position at the same time the SE bearing tree was moved.

A 31" P.Pine bears N 52-3/4° W, 33.0 ft to face (N 55° W, 50 lks), scribed S6BT and chaining notch.

A 23" P.Pine snag bears N 49-3/4° E, 19.8 ft to face (N 54° E, 30 lks), scribed S5BT and chaining notch.

A rotted stump bears S 61½° E, 26.8 ft to center (S 60° E, 41 lks). The remainder of this BT has been moved just North of the corner.

Description of monument and accessories I establish to perpetuate the original location of this corner:

I reestablish this corner at record distance from the Section 5 and 6 BTs. Set a 2½x28" aluminum monument 22" in the ground and buried the original stone on the North side.

I establish new bearing trees:

A 7" Fir bears S 61° W, 44.3 ft, scribed T10SR32ES7BT.

A 13" P.Pine bears N 34-3/4° E, 59.0 ft, scribed T10SR32ES5BT.

A 6" P.Pine bears S 30½° E, 37.1 ft, scribed T10SR32ES8BT.

T10S R32E

S61S5

----+----

S71S8

PLS1918

1988

New BTs have 3/4" brass washers marked PLS1918 attached to the BT blaze, faces and bands painted with red tree marking paint, and BT tags and Attention or Land Survey Monument signs. A steel fence post with Attention or Land Survey Monument sign is driven approximately 3-5 feet from the corner.

Sun Cadastral Survey, Cont No. 53-04H1-7-4011

Field Book: 4-37 & 6-18

Work accomplished: 8/24/88

Witnesses: Tyler Parsons, Sharon Parsons

Louise Parsons, Douglas Parsons

Job No.: 87221

PARSONS SURVEYING

1915 S.E. Stone Street

Corvallis, OR 97333

(503) 752-7515

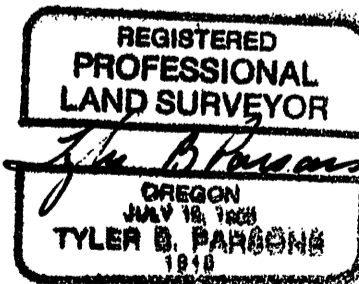

Office of COUNTY SURVEYOR

County of GRANT

State of OREGON

, I hereby certify that the within instrument was filed in this office for record on the 27th day of Feb, 1989

Robert D. Sargent by _____
(COUNTY OFFICIAL)

(DEPUTY)